

## Dimensional Documentation

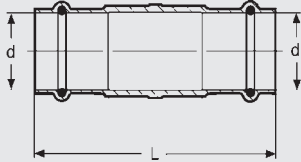

Coupling C x C Extended No Stop			
Stock Code	Size	Material	L (in)
	d		
78213	1/2"	Copper	2.9
78218	3/4"	Copper	3.3
78223	1"	Copper	3.7
78228	1-1/4"	Copper	4.1
78233	1-1/2"	Copper	4.7
78238	2"	Copper	5.2

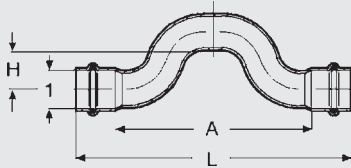

Cross-Over C x C					
Stock Code	Size	Material	A (in)	L (in)	H (in)
	1				
77742	1/2"	Copper	3.622	5.118	0.772
77747	3/4"	Copper	4.488	6.339	0.902

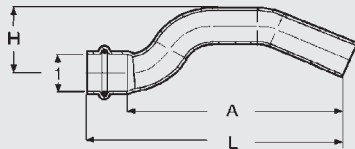

Cross-Over FTG x C Close Rough					
Stock Code	Size	Material	A (in)	L (in)	H (in)
	1				
78137	1/2"	Copper	3.835	4.583	1.098
78142	3/4"	Copper	4.638	5.543	1.539

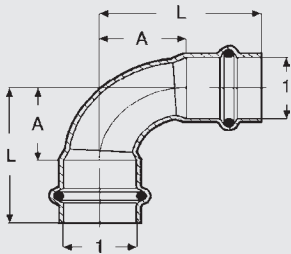

Elbow 90° C x C Close Rough				
Stock Code	Size	Material	A (in)	L (in)
	1			
77317	1/2"	Copper	0.748	1.496
77322	3/4"	Copper	1.039	1.945
77327	1"	Copper	1.323	2.228
77332	1-1/4"	Copper	1.654	2.677
77337	1-1/2"	Copper	1.984	3.402
77342	2"	Copper	2.551	4.126

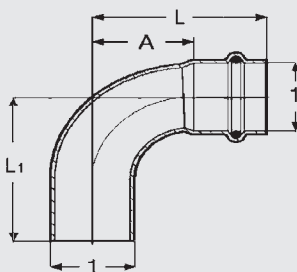

Elbow 90° FTG x C Close Rough					
Stock Code	Size	Material	A (in)	L (in)	L1 (in)
	1				
77347	1/2"	Copper	0.748	1.496	1.535
77352	3/4"	Copper	1.039	1.945	1.984
77357	1"	Copper	1.323	2.228	2.268
77362	1-1/4"	Copper	1.654	2.677	2.756
77367	1-1/2"	Copper	1.984	3.402	3.480
77372	2"	Copper	2.551	4.126	4.205

## Dimensional Documentation

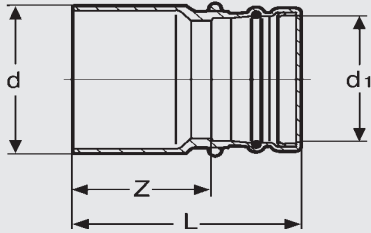

Reducer FTG x C				
Stock Code	Material	Size	Z (in)	L (in)
		d d1		
91452	Bronze	3"x 2"	3.031	4.606
91457	Bronze	3"x 2-1/2"	2.819	4.921
17593	Bronze	4"x 2-1/2"	3.543	5.650
91472	Bronze	2-1/2"x 1-1/2"	3.150	4.567

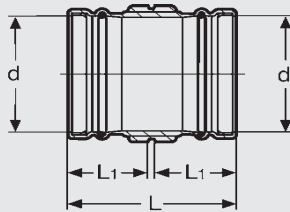

Coupling C x C No Stop				
Stock Code	Material	Size	L (in)	L1 (in)
		d		
91477	Bronze	2-1/2"	4.528	2.185
91482	Bronze	3"	4.528	2.185
91487	Bronze	4"	5.315	2.579

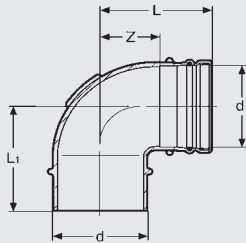

Elbow 90° FTG x C					
Stock Code	Material	Size	Z (in)	L (in)	L1 (in)
		d			
91492	Bronze	2-1/2"	2.224	4.331	4.606
91497	Bronze	3"	2.559	4.685	4.803
91502	Bronze	4"	2.972	5.472	5.591

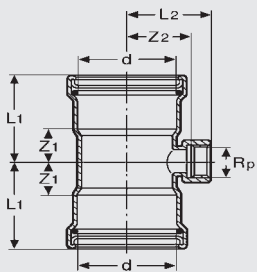

Tee C x C x F						
Stock Code	Material	Size	Z1 (in)	Z2 (in)	L1 (in)	L2 (in)
		d d Rp				
91507	Bronze	4"x4"x2"	1.535	2.717	4.035	3.583
91512	Bronze	4"x4"x3/4"	1.220	2.520	3.740	3.209
91517	Bronze	2-1/2"x2-1/2"x2"	1.929	1.929	4.035	2.795
91522	Bronze	2-1/2"x2-1/2"x3/4"	1.240	1.772	3.346	2.461
91527	Bronze	3"x3"x2"	1.929	2.205	4.035	3.071
91532	Bronze	3"x3"x3/4"	1.220	2.047	3.346	2.756

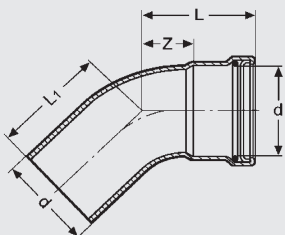

Elbow 45° FTG x C					
Stock Code	Material	Size	Z (in)	L (in)	L1 (in)
		d			
91537	Bronze	2-1/2"	1.142	3.248	3.819
91542	Bronze	3"	1.240	3.346	4.094
91547	Bronze	4"	1.417	3.898	4.921

## Dimensional Documentation

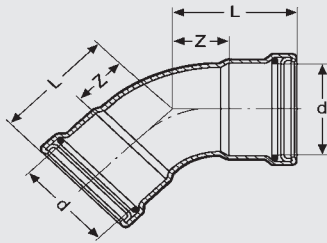

Elbow 45° C x C				
Stock Code	Material	Size	Z (in)	L (in)
		d		
20653	Copper	2-1/2"	1.476	3.169
20658	Copper	3"	1.732	3.701
20663	Copper	4"	2.224	4.587

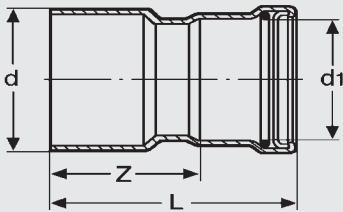

Reducer FTG X C				
Stock Code	Material	Size	Z (in)	L (in)
		d d1		
20758	Copper	2-1/2" x 2"	2.264	3.858
20763	Copper	3" x 2"	2.815	4.409
20768	Copper	3" x 2-1/2"	2.559	4.252
20773	Copper	4" x 2"	4.232	5.807
20778	Copper	4" x 2-1/2"	4.173	5.787
20783	Copper	4" x 3"	3.957	5.846
20813	Copper	2-1/2" x 1-1/2"	2.480	3.937
20818	Copper	3" x 1-1/2"	3.346	4.803

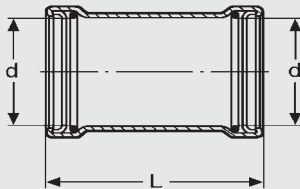

Coupling C x C No Stop			
	Material	Size	L (in)
		d	
20743	Copper	2-1/2"	4.331
20748	Copper	3"	4.921
20753	Copper	4"	5.787

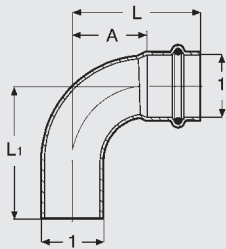

Elbow 90° FTG X C					
Stock Code	Material	Size	A (in)	L (in)	L1 (in)
		1			
20638	Copper	2-1/2"	3.189	4.882	4.803
20643	Copper	3"	3.760	5.728	5.630
20648	Copper	4"	4.902	7.264	7.126

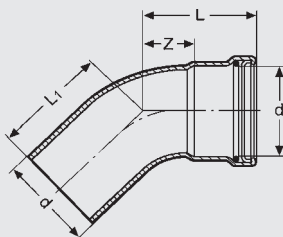

Elbow 45° FTG x C					
Stock Code	Material	Size	Z (in)	L (in)	L1 (in)
		d			
20668	Copper	2-1/2"	1.476	3.169	3.091
20673	Copper	3"	1.732	3.701	3.602
20678	Copper	4"	2.224	4.587	4.449